

Rear Upper Arm Kit Installation Instructions SPL RUA G29

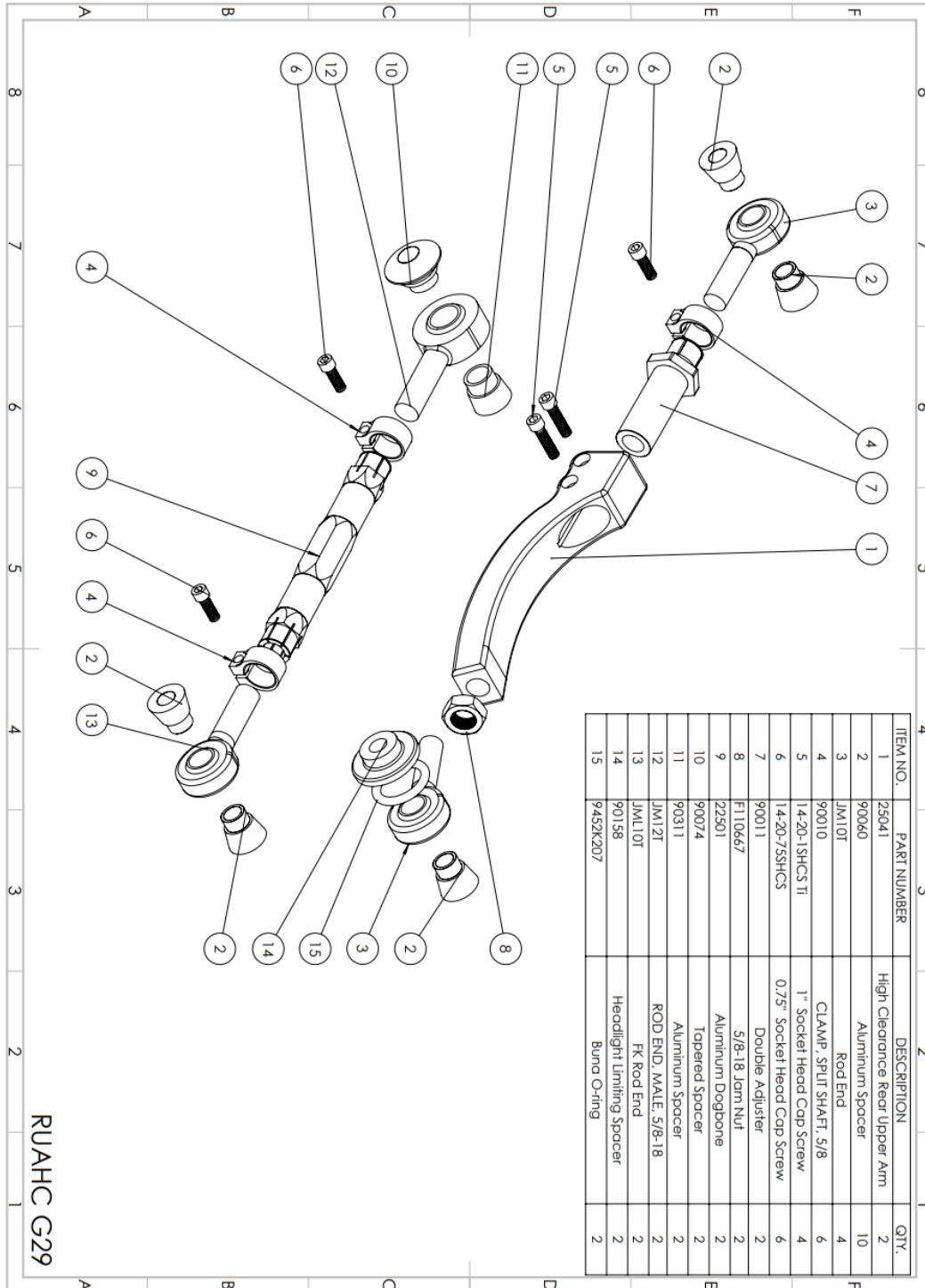

Rear Upper Camber Arm Instructions

1. Remove the OEM arm. We suggest removing and installing one arm at a time. It makes the full installation easier.
2. Set SPL Parts Arm next to the OEM arm. Use the bolts through the stock arm to set the SPL Parts Arm to the exact length of the OEM arm, ensuring equal thread engagement on both ends. **DO NOT ADJUST THE ROD END HELD ON AT THE JAM NUT (8)**. Adjust using the double adjuster (7) hex.
3. Install the SPL Parts Arm using the OEM hardware with the double adjuster end at the outboard side. Tighten the bolts to **74 ft. lbs.** (100 N/M) at both ends. **DO NOT OVERTORQUE.** *SPL Parts is not liable for any issues due to overtorque.*
4. Once the arm is installed, check both FK Rod Ends (3) are centered in their articulation and locked. Tighten the Blue Titanium Socket Head Cap Screws (5, 6) until the assembly does not rotate, a maximum of **150 IN. lbs.**
5. Professional alignment is recommended. Take your vehicle to an alignment shop, bringing these instructions with you to ensure that the arm is adjusted correctly.



Rear Upper Traction Link Instructions

1. Remove the OEM arm. The knuckle side of this arm may require a breaker bar as it is very tight, and the subframe side requires you to lower the subframe to remove the bolt. You can lower one side of the subframe at a time if it makes it easier, and we suggest placing the bolt back in the other direction so the subframe does not need to be lowered again to remove this arm.

2. Set the SPL Parts Arm next to the OEM arm. Use the bolts through the stock arm to set the SPL Parts Arm to the exact length of the OEM arm ensuring equal thread engagement on both ends. Please refer to the next picture. Note the groove on one side of the SPL Parts Arm to indicate the left-hand threads.

3. Install the SPL Parts Arm using the OEM hardware. Please ensure the Tapered Spacer (10) provided mates up with the tapered section of the knuckle. Tighten the bolts at the subframe to 74 **ft.-lbs.** and the bolts at the knuckle to 135 **ft.-lbs.** **DO NOT OVERTORQUE!** *SPL Parts is not liable for any issues due to overtorque.*



4. Once installed, ensure that both of the FK Rod Ends (12, 13) are centered and have full articulation. Lock them in place by tightening the Blue Titanium Socket Head Cap Screws (6) with a 3/16 allen wrench until the assembly does not rotate, to a maximum of 150 **IN. lbs.**

5. Professional alignment is recommended. Take your car to an alignment shop and bring these instructions with you to ensure that the arm is adjusted correctly.

Adjusting the Length of the Links for Alignment

Loosen the Aluminum Clamps on both ends of the Aluminum Dogbone. Turn the Dogbone so as to thread in/out the FK Rod Ends. Threading in/out the Dogbone will in turn thread out/in both rod ends. Once the assembly is the correct length, tighten down the Aluminum Clamps by torquing the Blue Titanium Socket Head Cap Screws (5) to 150 **in. lbs**. Note the thread engagement should not exceed the measurement pictured on the right (0.625").



ONE-YEAR LIMITED WARRANTY AND DISCLAIMER

All SPL brand products are intended for **Off Road Use Only** and carry a one year limited warranty. See below for details. All other branded products carry their respective manufacturer warranty.

SPL PRO suspension products warranted to be free of defects in material and workmanship for one (1) year from the date of purchase.

If a product fails to meet specifications, SPL PARTS INC will, at its election, repair, replace, or make appropriate adjustment, if SPL PARTS INC determines to its satisfaction that the product is defective in material or workmanship, i.e. contains a defect arising out of the manufacture of the product and not a defect caused by other circumstances, including, but not limited to accident, misuse, abuse, unforeseeable use, neglect, alteration, improper installation, improper adjustment, improper repair, or failure caused by other equipment or interaction with other equipment. SPL PARTS INC is not responsible for labor charges, removal charges, installation, or other incidental or consequential costs. In no event shall the liability of SPL PARTS INC exceed the purchase price of the product.

SPL PARTS INC makes no other warranties, either expressed or implied, including limitation warranties as to merchantability or fitness for a particular purpose. SPL PARTS INC shall not be liable for, and buyer assumes all risk of, any advice or failure to provide advice by SPL PARTS INC to buyer regarding the product or use and installation of product. SPL PARTS INC shall not be liable for any special, incidental or consequential damages.

If the purchaser of the product shall fail to pay when due any portion of the purchase price, or fail to meet any terms required under contract agreed on at time of purchase, all warranties and remedies granted may be terminated.

Using any SPL arm as a tie/strap down point for a dyno session or transport will void the warranty.